

# SUBMITTAL DATA SHEET

No-Lead  
Stub Out Elbow – 2590

PEX x Spun Closed End

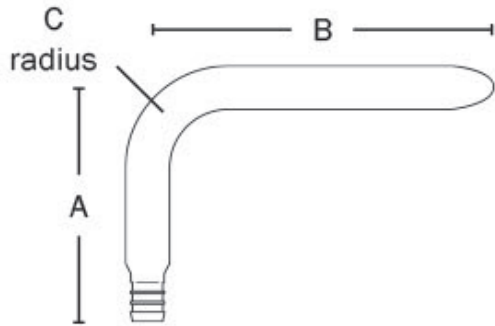

## Dimensions

PEX Connection	A	B	C
1/2"	3 1/2"	6"	1 1/4"
1/2"	3 1/2"	8"	1 1/4"
3/4"	4 1/2"	8"	1 1/4"

### Step 1

Crimp PEX tube to a straight PEX stub out or a stub out elbow depending on whether you need to make a turn as you come through the wall. Make sure stub out is properly secured.

#### YOU'LL NEED

- Crimp tool
- Crimp rings
- Plastic Hangers

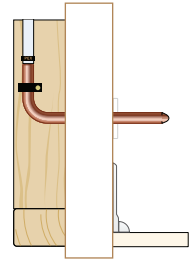

### Step 2

Cut the spun closed end off of the stub out, then deburr and clean the outside of the tube with sand cloth.

#### YOU'LL NEED

- Copper cutting/deburring tool
- Sand Cloth

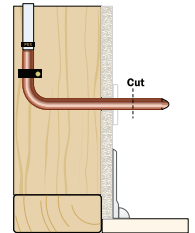

### Step 3

Using two wrenches, compress the stop onto the copper tube. Be careful not to overtighten the joint.

#### YOU'LL NEED

- Wrenches
- Quarter turn supply stop

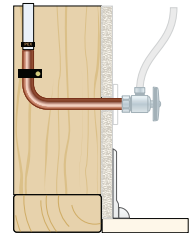

## SUBMITTAL INFORMATION

- Available Sizes:
  - 1/2" x 3 1/2" x 6"
  - 1/2" x 3 1/2" x 8"
  - 3/4" x 4 1/2" x 8"
- 60 PSI
- Max Temperature: 392°F
- Material: C46500
- Pex end conforms to ASTM F1807
- Accepts sweat, push-fit and compression valves

NO-LEAD: The weighted average of the wetted surface of this no-lead product contacted by consumable water contains less than one quarter of one percent (0.25%) lead.



**A.Y. McDonald Mfg. Co.**  
4800 Chavenelle Rd  
Dubuque, IA 52002

**Toll Free: 1-800-292-2737**  
sales@aymcdonald.com  
aymcdonald.com

A.Y. McDonald considers the information on this assembly drawing correct when published. Item and option availability, including specifications, are subject to change without notice.

**Submitted by:**