

# SUBMITTAL DATA SHEET

## Pump Repair Parts

### 8100 / 8200 Series Repair Parts

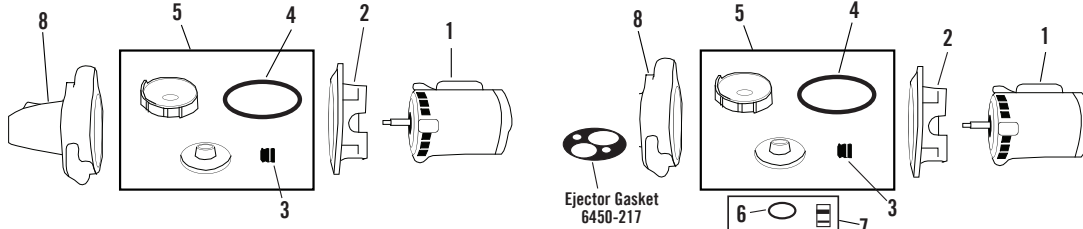

**8100 SHALLOW WELL SERIES**

**8200 CONVERTIBLE SERIES**

	(1) Motor	(5) Impeller / Diffuser Kit*	Impeller	Diffuser
HP	Part #	Part #	Part #	Part #
8130, 8130HP 8230	6155-240	6127-324	6155-359	6130-201
8131, 8131HP, 8231	6155-240	6127-325	6155-331	6130-201
8150, 8150HP, 8250	6155-240	6127-326	6155-358	6130-201
8151, 8151HP, 8251	6155-240	6127-327	6155-330	6130-201
8170, 8170HP, 8270	6155-241	6127-328	6155-370	6155-223
8171, 8171HP, 8271	6155-241	6127-329	6155-334	6155-223
8110, 8110HP, 8210	6155-242	6127-330	6155-369	6155-223
8111, 8111HP, 8211	6155-242	6127-331	6155-333	6155-223

\*Kit includes impeller, diffuser, rotary seal & housing gasket with instructions

Part #	Description
6156-140	2 Adapter
6422-500	3 Rotary Seal
6155-224	4 Housing Gasket D09 or Older
3138-995	4 O-ring E09 or Newer
3134-114	6 Regulating Valve assembly O-ring
6155-238	7 Regulating Valve assembly
6155-236	8 8100 Pump Body assembly
6155-237	8 8200 Pump Body assembly

#### Miscellaneous Parts (Not shown above)

Part #	Description
6127-248	Pump Foot
3100-530	Foot Capscrews
3100-528	Adapter Capscrews
5999-903	Diffuser Screws
3110-951	Regulating Valve Set Screw
6450-217	Ejector Gasket
5999-958	Bolt-on Jet Body

#### Shallow Well Venturi - Nozzle - O-ring Assemblies

HP	Models	Part #
1/3	8130-8131, 650JP, 8530, 8531	6155-203
1/2	8150-8151, 651JP, 8550, 8551	6155-204
3/4	8170-8171, 652JP, 8570, 8571	6155-212
1	8110-8111, 653JP, 8510, 8511	6155-213
1/3	8130HP, 8131HP, 654JP, 8530HP, 8531HP	6155-202
1/2	8150HP, 8151HP, 655JP, 8550HP, 8551HP	6155-205
3/4	8170HP, 8171HP, 656JP, 8570HP, 8571HP	6155-211
1	8110HP, 8111HP, 657JP, 8510HP, 8511HP	6155-214
1/2	8350HP	6156-151
1/2	8350	6156-147
	Nozzle/venturi o-ring for assemblies	3134-120

#### Deep Well Kits - Jet Package

Models	Venturi		Nozzle
	Part #	Part #	Part #
7502JP, 7733JP	6413-203	6128-201	6128-201
7503JP, 7734JP	6413-204	6128-201	6128-201
7508JP, 7735JP	6414-207	6128-201	6128-201
7509JP, 7736JP	6414-208	6128-201	6128-201
7901JP, 7808JP	6413-250	6413-246	6413-246
7902JP, 7809JP	6413-249	6413-246	6413-246
7903JP, 7810JP	6413-248	6413-246	6413-246
7906JP, 7812JP	6413-253	6413-246	6413-246
7907JP, 7813JP	6413-254	6413-246	6413-246

**NO-LEAD:** The weighted average of the wetted surface of this no-lead product contacted by consumable water contains less than one quarter of one percent (0.25%) lead.



**A.Y. McDonald Mfg. Co.**  
4800 Chavenelle Rd  
Dubuque, IA 52002

**Toll Free: 1-800-292-2737**  
sales@aymcdonald.com  
aymcdonald.com

A.Y. McDonald considers the information on this assembly drawing correct when published. Item and option availability, including specifications, are subject to change without notice.

**Submitted by:**