

SUBMITTAL DATA SHEET

NL Plug Style Corporation Stop – 74704-22

MNPT x -22 CTS Compression

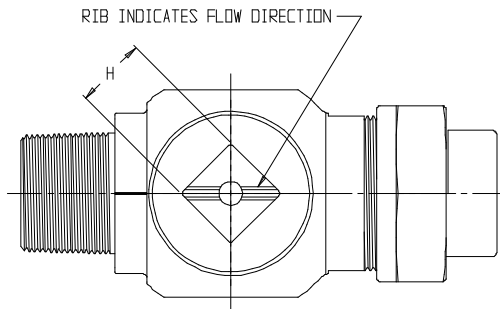

*NOTE: 1 1/2 & 2 INCH PLUGS HAVE SQUARE HEAD WRENCHING SURFACES

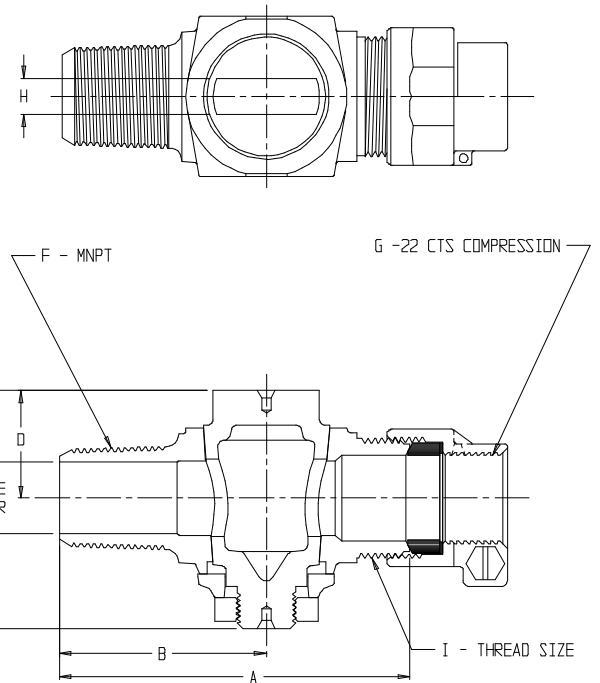

| MODEL | SIZE | A | B | C | D | E | F | G | H | I |
|------------|---------|------|------|------|------|------|-------|-------|-------|--------------------|
| 74704-22 | 1/2 | 2.98 | 1.73 | 2.28 | 1.12 | .53 | 1/2 | 1/2 | .34 | 1/2 AWWA FLARE |
| 74704-22 | 3/4 | 3.66 | 2.15 | 2.50 | 1.13 | .75 | 3/4 | 3/4 | .38 | 3/4 AWWA FLARE |
| 74704-22 | 3/4 X 1 | 3.87 | 2.15 | 2.50 | 1.13 | .75 | 3/4 | 1 | .38 | 1 AWWA FLARE |
| 74704-22 | 1 | 4.25 | 2.40 | 2.89 | 1.41 | 1.00 | 1 | 1 | .38 | 1 AWWA FLARE |
| 74704-22 | 1 1/4 | 5.31 | 2.94 | 3.44 | 1.67 | 1.25 | 1 1/4 | 1 1/4 | .44 | 1 1/4 AWWA FLARE |
| 74704-22 | 1 1/2 | 6.06 | 3.35 | 4.26 | 1.98 | 1.50 | 1 1/2 | 1 1/2 | *1.13 | 2 1/8 - 16 SPECIAL |
| 74704-22 | 2 | 7.30 | 3.97 | 4.80 | 2.39 | 2.00 | 2 | 2 | *1.25 | 2 5/8 - 16 SPECIAL |
| 74704-22FT | 1 1/2 | 6.23 | 3.35 | 4.26 | 1.98 | 1.50 | 1 1/2 | 1 1/2 | *1.13 | 1 1/2 AWWA FLARE |
| 74704-22FT | 2 | 7.30 | 3.97 | 4.80 | 2.39 | 2.00 | 2 | 2 | *1.25 | 2 AWWA FLARE |

SUBMITTAL INFORMATION

- Manufactured in compliance with ANSI/AWWA C800 (latest revision)
- Brass components in contact with potable water conform to ASTM B584, UNS C89833 (latest revision) and identified with "NL"
- Certified to NSF/ANSI 61 and NSF/ANSI 372
- Brass components not in contact with potable water conform to ASTM B62 and ASTM B584, UNS C83600 -85-5-5-5 (latest revision)
- Large wrench flats provided for proper installation
- Plug rotates 360°
- 1/2" – 1" rated for 100 PSIG water pressure
- 1 1/4" – 2" rated for 80 PSIG water pressure
- Insert stiffeners required on all flexible plastic connections



A.Y. McDonald Mfg. Co.
4800 Chavenelle Rd
Dubuque, IA 52002

Toll Free: 1-800-292-2737
sales@aymcdonald.com
aymcdonald.com

A.Y. McDonald considers the information on this assembly drawing correct when published. Item and option availability, including specifications, are subject to change without notice.

Submitted by: