

# SUBMITTAL DATA SHEET

NL Plug Style Corporation Stop – 74704G

MNPT x G CTS Compression

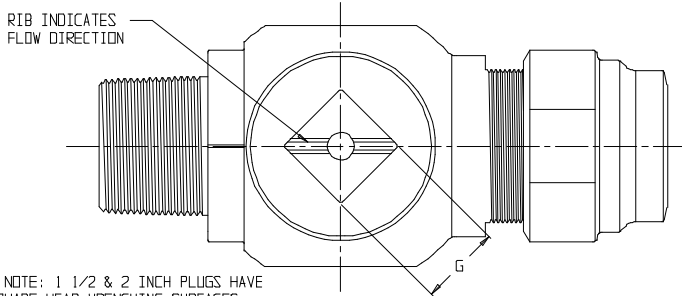

\* NOTE: 1 1/2 & 2 INCH PLUGS HAVE SQUARE HEAD WRENCHING SURFACES

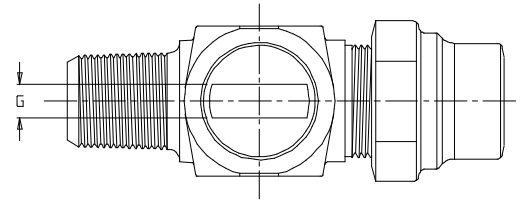

MODEL NO.	SIZE	A	B	C	D	E	F	G	H
74704G	3/4	3.66	2.50	1.13	.75	3/4	3/4	.38	3/4 AWWA FLARE
74704G	3/4 X 1	3.87	2.50	1.13	.75	3/4	1	.38	1 AWWA FLARE
74704G	1	4.25	2.89	1.41	1.00	1	1	.38	1 AWWA FLARE
74704G	1 1/4	5.31	3.44	1.67	1.25	1 1/4	1 1/4	.44	1 1/4 AWWA FLARE
74704G	1 1/2	6.06	3.35	2.00	1.50	1 1/2	1 1/2	1.13*	2 1/8 - 16 SPECIAL
74704G	2	7.30	4.82	2.41	2.00	2	2	1.25*	2 5/8 - 16 SPECIAL
74704GFT	1 1/2	6.23	3.35	2.00	1.50	1 1/2	1 1/2	1.13*	1 1/2 AWWA FLARE
74704GFT	2	7.30	4.82	2.41	2.00	2	2	1.25*	2 AWWA FLARE

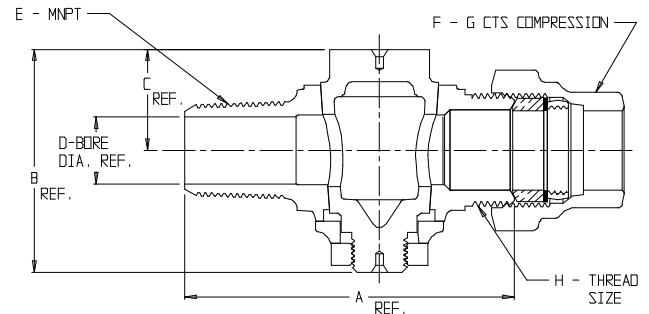

## SUBMITTAL INFORMATION

- Manufactured in compliance with ANSI/AWWA C800 (latest revision)
- Brass components in contact with potable water conform to ASTM B584, UNS C89833 (latest revision) and identified with "NL"
- Certified to NSF/ANSI 61 and NSF/ANSI 372
- Brass components not in contact with potable water conform to ASTM B62 and ASTM B584, UNS C83600 -85-5-5-5 (latest revision)
- Large wrench flats provided for proper installation
- Plug rotates 360°
- 1/2" – 1" rated for 100 PSIG water pressure
- 1 1/4" – 2" rated for 80 PSIG water pressure
- Insert stiffeners required on all flexible plastic connections



**A.Y. McDonald Mfg. Co.**  
4800 Chavenelle Rd  
Dubuque, IA 52002

**Toll Free: 1-800-292-2737**  
sales@aymcdonald.com  
[aymcdonald.com](http://aymcdonald.com)

A.Y. McDonald considers the information on this assembly drawing correct when published. Item and option availability, including specifications, are subject to change without notice.

**Submitted by:**