

SUBMITTAL DATA SHEET

NL Service Fitting – 74742LF

Lead Flange x Copper Flare

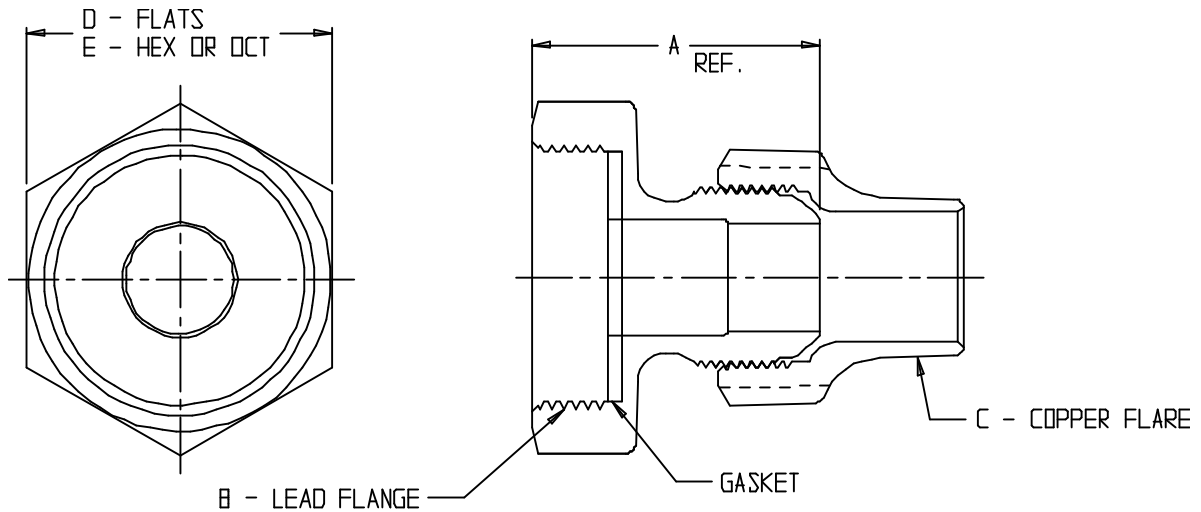

| MODEL | SIZE | A | B | C | D | E |
|---------|-----------|------|-----|-----|------|-----|
| 74742LF | 5/8 X 3/4 | 1.95 | 5/8 | 3/4 | 2.13 | HEX |
| 74742LF | 3/4 | 2.00 | 3/4 | 3/4 | 2.13 | HEX |
| 74742LF | 1 | 2.05 | 1 | 1 | 2.44 | OCT |

SUBMITTAL INFORMATION

- Manufactured in compliance with ANSI/AWWA C800 (latest revision)
- Brass components in contact with potable water conform to ASTM B584, UNS C89833 (latest revision) and identified with “NL”
- Certified to NSF/ANSI 61 and NSF/ANSI 372
- Brass components not in contact with potable water conform to ASTM B62 and ASTM B584, UNS C83600 -85-5-5-5 (latest revision)
- Large wrench flats provided for proper installation



A.Y. McDonald Mfg. Co.
4800 Chavenelle Rd
Dubuque, IA 52002

Toll Free: 1-800-292-2737
sales@aymcdonald.com
aymcdonald.com

A.Y. McDonald considers the information on this assembly drawing correct when published. Item and option availability, including specifications, are subject to change without notice.

Submitted by: