

# SUBMITTAL DATA SHEET

NL Service Fitting – 74758Q-11

Q CTS Compression x -11 Ranger Compression



D - Q CTS  
COMPRESSION

B - FLATS  
C - HEX OR OCT

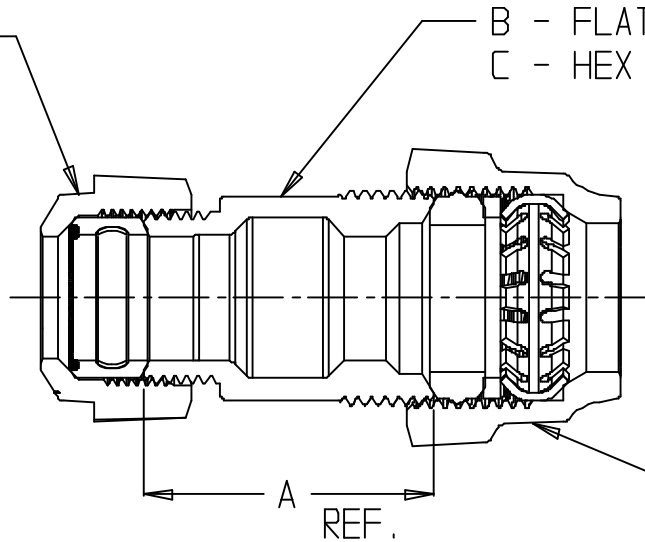

E - RANGER  
COMPRESSION

MODEL	SIZE	A	B	C	D	E	PIPE /TUBE SIZE RANGE (in)
74758Q-11	3/4	2.11	1.38	OCT	3/4	3/4	.871-1.089

NOTE: McDONALD RANGER NUTS ARE NOT  
COMPATIBLE WITH OTHER MANUFACTURERS  
COMPRESSION NUT SYSTEMS  
McDONALD RANGER NUTS ARE NOT  
COMPATIBLE WITH OTHER McDONALD  
COMPRESSION NUT SYSTEMS

## SUBMITTAL INFORMATION

- Manufactured in compliance with ANSI/AWWA C800 (latest revision)
- Brass components in contact with potable water conform to ASTM B584, UNS C89833 (latest revision) and identified with "NL"
- Certified to NSF/ANSI 61 and NSF/ANSI 372
- Brass components not in contact with potable water conform to ASTM B62 and ASTM B584, UNS C83600 -85-5-5-5 (latest revision)
- Large wrench flats provided for proper installation
- Insert stiffeners required on all flexible plastic connections



A.Y. McDonald Mfg. Co.  
4800 Chavenelle Rd  
Dubuque, IA 52002

Toll Free: 1-800-292-2737  
sales@aymcdonald.com  
[aymcdonald.com](http://aymcdonald.com)

A.Y. McDonald considers the information on this assembly drawing correct when published. Item and option availability, including specifications, are subject to change without notice.

Submitted by: