

# SUBMITTAL DATA SHEET

## Waste Water Effluent | Sewage Ejectors | Grinders 1 - 2 HP Grinder Pumps



1 & 2 HP grinder pumps that have a 1 1/4" vertical discharge (optional 2" FNPT adapter available), and can grind up to 3" solids, and be installed on a rail system or with the supplied legs. Residential developments, commercial developments and wastewater applications.

### Motor

Internal capacitor run 115V or 208-230V, oil filled motors with upper and lower ball bearings and thermal overload protection

- Constant bearing lubrication
- Maximum motor cooling
- Runs cooler and lasts longer
- Internal overload protection
- Quiet operation
- Fasteners and shaft made from rugged, corrosion resistant stainless steel

### Performance

- Heads up to 103' TDH
- Flows up to 44 GPM

### Warranty

- 3 Years from date of manufacture

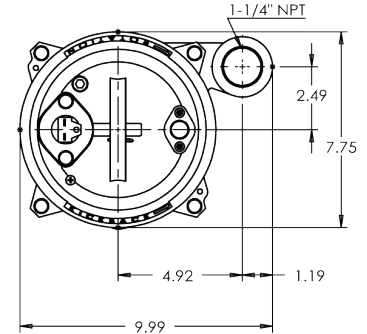

### Performance Curve

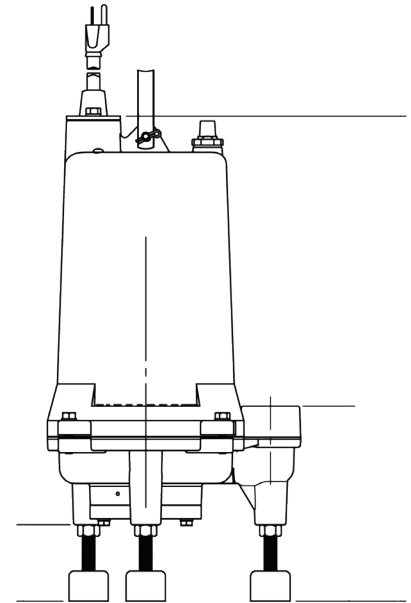
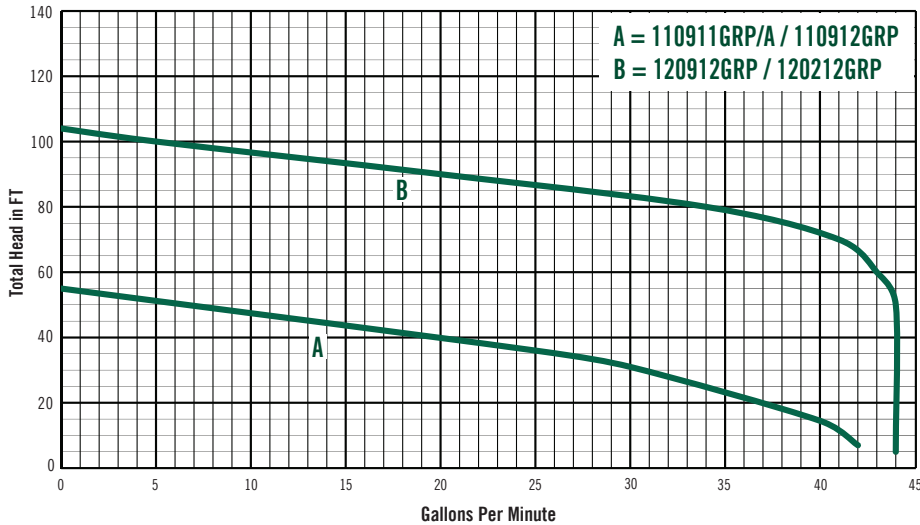

**NO-LEAD:** The weighted average of the wetted surface of this no-lead product contacted by consumable water contains less than one quarter of one percent (0.25%) lead.



**A.Y. McDonald Mfg. Co.**  
4800 Chavenelle Rd  
Dubuque, IA 52002

**Toll Free: 1-800-292-2737**  
sales@aymcdonald.com  
aymcdonald.com

A.Y. McDonald considers the information on this assembly drawing correct when published. Item and option availability, including specifications, are subject to change without notice.

**Submitted by:**

# SUBMITTAL DATA SHEET

Waste Water  
Effluent | Sewage Ejectors | Grinders  
**1 - 2 HP Grinder Pumps**



## Seal Design

Single, mechanical, running in oil filled chamber allowing dry run and cooling

## Impeller Design

- Non-clog style, cast-iron vortex impeller
- Designed to generate higher heads and reduce clogging by foreign materials
- Provides non-overloading performance

## Cutter Assembly

- 440 SST (56-60 Rockwell)
- 24,000 cuts per second and 1.5 million cuts a minute
- Designed to reduce over loading and clogging

## Power Cord

- Sealed entry quick disconnect power cords
- Prevents water from entering the motor housing through a cut cord
- Easy to replace in the field
- Available in lengths up to 100'

## Switch

- Piggy-back switch design
- Defective switches can be diagnosed over the phone
- Pump can be operated manually or supplied with other piggy-back switches
- Switch can be replaced

## Technical Data

Discharge	1 1/4" NPT. vertical standard or optional 2"
Liquid Temperature	140°F (Intermittent)
Motor Housing	Cast Iron
Volute	Cast Iron
Seal Plate	Cast Iron
Impeller	Cast Iron / Vortex
Solids Handling	3"
Shaft	Stainless Steel
Seal Plate	Cast Iron
Shaft Seal (Single Seal)	Single Mechanical, carbon-Rotating Face, Ceramic-Stationary Face, Buna-N Elastomer, 300 Series Stainless Steel Hardware
Bearings (Upper & Lower)	Single row, ball, oil lubricated
Hardware	300 Series stainless steel
O-rings	Buna-N
Cord	20' Length standard. Up to 30' with plug and 100' without plug.
Motor (Single Phase)	1 or 2 HP 3450 RPM. 60Hz, Includes. Overload Protection in the motor, oil filled, Class F Permanent Split Capacitor
Weight	75 / 78 lbs (Manual)

Part No.	Model	HP	Volts	Phase	AMPS	Cord Length	Switch
6194-001	110911GRP	1	115	1	13	20'	Manual
6194-002	110911GRPA	1	115	1	13	20'	Wide-Angle Float
6194-011	110912GRP	1	208-230	1	6.5	20'	Manual
6194-003	120912GRP	2	208-230	1	15	20'	Manual
6194-012	120212GRP*	2	208-230	1	15	20'	Manual

\*Requires external capacitors

NO-LEAD: The weighted average of the wetted surface of this no-lead product contacted by consumable water contains less than one quarter of one percent (0.25%) lead.



**A.Y. McDonald Mfg. Co.**  
4800 Chavenelle Rd  
Dubuque, IA 52002

**Toll Free: 1-800-292-2737**  
sales@aymcdonald.com  
aymcdonald.com

A.Y. McDonald considers the information on this assembly drawing correct when published. Item and option availability, including specifications, are subject to change without notice.

**Submitted by:**