

SUBMITTAL DATA SHEET

Gas Non-Insulated Swivels – Offset Swivels

MNPT

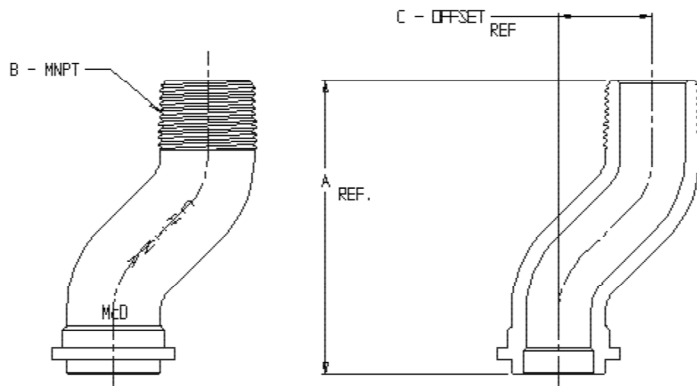

SIZE	BLACK PART NUMBER	GALVANIZED PART NUMBER	A	B	C
5LT	4815-667	N/A	2.13	1/2	.38
5LT	N/A	N/A	3.00	1/2	1.25
10-5LT	4815-679	4815-681	4.00	1/2	3.00
1DLT	4815-505	N/A	3.13	3/4	1.00
10LT	4815-675	N/A	3.25	3/4	1.25
1A	4815-515	N/A	2.69	3/4	1.00
20-5LT	4815-541	N/A	3.50	1/2	3.00
20-10LT	4815-683	N/A	3.75	3/4	1.63
20-1DLT	4815-712	N/A	3.50	3/4	3.63
2DLT	4815-511	4815-527	3.50	1	1.00
2DLT	4815-584	N/A	3.78	1	1.25
30-1DLT	4815-840	4815-842	4.00	3/4	3.00
30-20LT	4815-616	4815-618	3.78	1	1.25
3DLT	4815-547	4815-561	3.75	1 1/4	1.00
3DLT	4815-871	4815-872	3.75	1 1/4	1.50
45-30LT	4815-652	4815-654	4.00	1 1/4	1.63
45LT	4815-570	4815-580	4.00	1 1/2	1.00
45LT	4815-572	4815-582	5.50	1 1/2	2.50
6DLT	4815-879	4815-880	5.38	1 1/2	1.50
6DLT	4815-884	4815-886	8.75	1 1/2	4.50
#3 #4	N/A	4815-908	8.75	1 1/2	4.50

SUBMITTAL INFORMATION

- Rated for natural, manufactured, or LP gas
- Iron castings conform to ASTM A47 or ASTM A536 (latest revision), with optional galvanized coating
- Pipe threads manufactured in compliance with ASME/ANSI B1.20.1 (latest revision)



A.Y. McDonald Mfg. Co.
4800 Chavenelle Rd
Dubuque, IA 52002

Toll Free: 1-800-292-2737
sales@aymcdonald.com
aymcdonald.com

A.Y. McDonald considers the information on this assembly drawing correct when published. Item and option availability, including specifications, are subject to change without notice.

Submitted by: